



PUTTERILLS

est. 1992

**£995 Per Month**  
**Millstream Close**

Hitchin, SG4 0DA



## PROPERTY SUMMARY

This beautifully refurbished one-bedroom apartment in Millstream Close has recently undergone a complete refurbishment, ensuring that everything is in pristine condition for you to 'just move in'. The interior boasts a contemporary aesthetic with wooden floors throughout, creating a warm and inviting atmosphere. The kitchen and

bathroom have been stylishly refitted, featuring brand-new appliances.

Situated within easy access to the vibrant life of Hitchin town centre. Here, you'll find an array of shops, a traditional market, and a variety of restaurants, bars, and pubs nestled within its historic streets. Leisure

facilities like a swimming centre, theatres, and a library enrich the living experience. For commuters, the proximity to the mainline railway station is within walking distance with trains to Kings Cross just 30 minutes and direct road links to the A1(M).

1



1



1













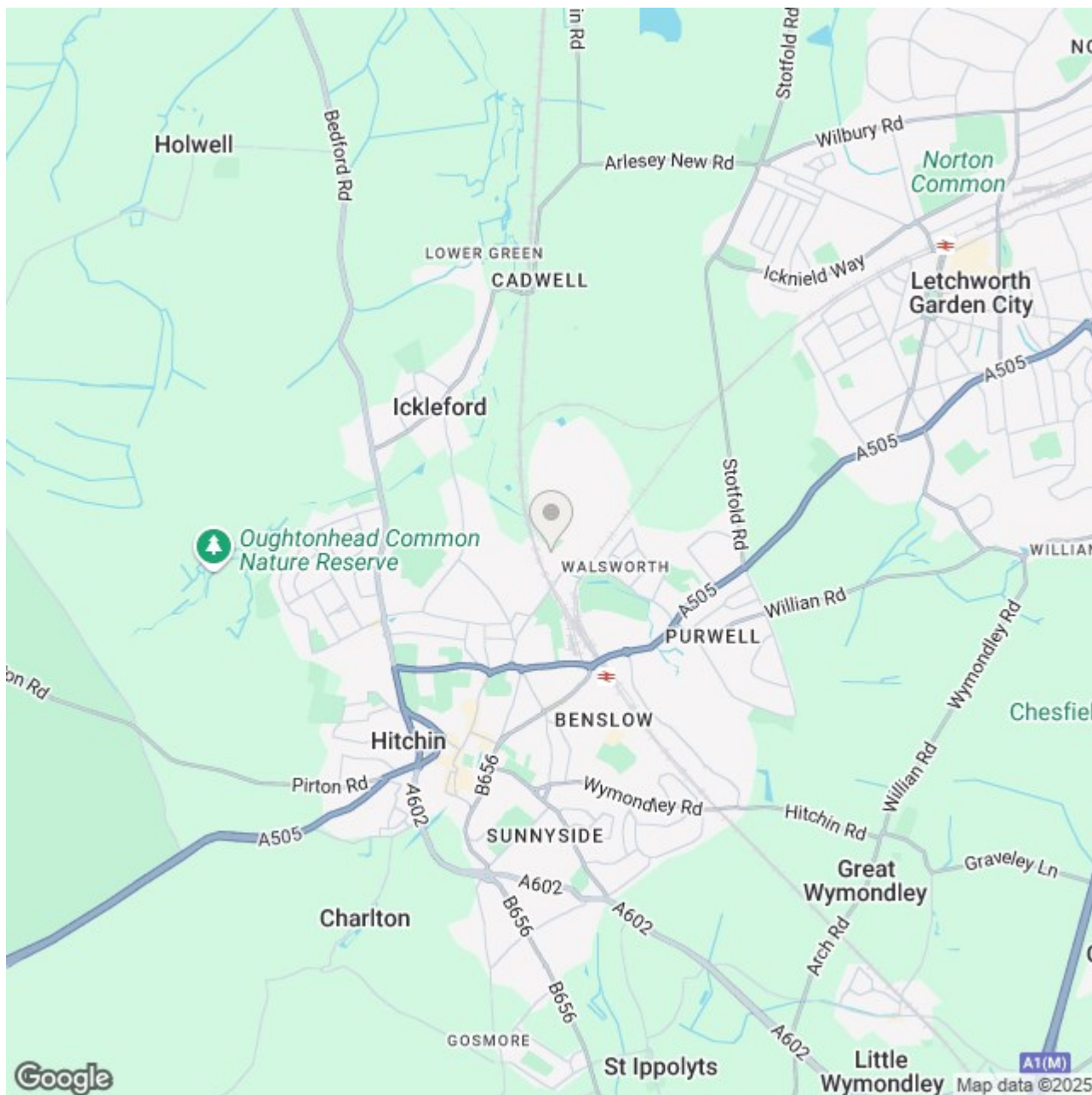

**LOCAL AUTHORITY**  
North Herts

**TENURE**

**COUNCIL TAX BAND**  
B

**VIEWINGS**  
By prior appointment only

## Ground Floor

Approx. 34.7 sq. metres (373.2 sq. feet)

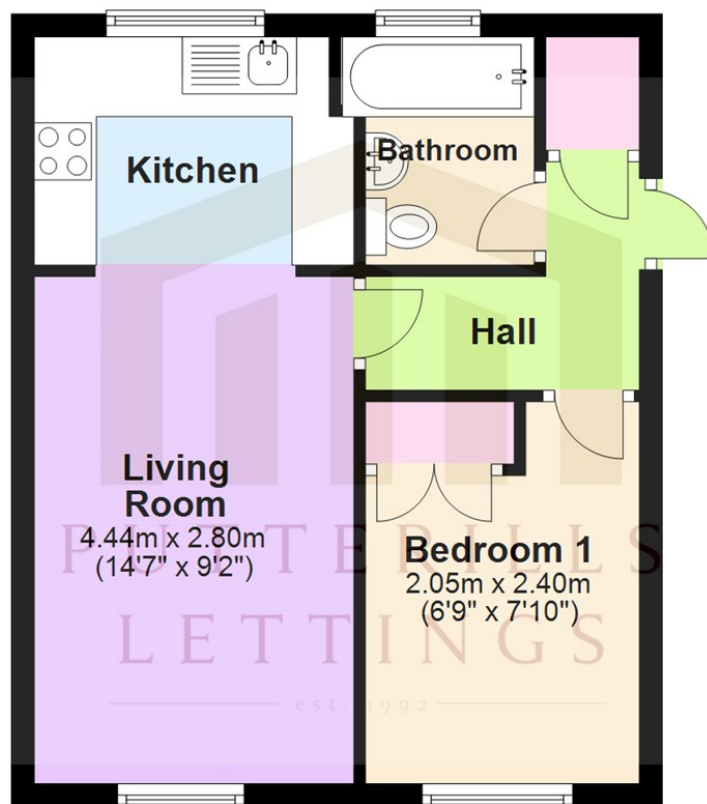

Total area: approx. 34.7 sq. metres (373.2 sq. feet)

Approximate measurements not to scale for room identification purposes only

Plan produced using PlanUp.

## Energy Efficiency Rating

	Current	Potential
Very energy efficient - lower running costs		
(92 plus) <b>A</b>		
(81-91) <b>B</b>		
(69-80) <b>C</b>		
(55-68) <b>D</b>	<b>55</b>	
(39-54) <b>E</b>		
(21-38) <b>F</b>		
(1-20) <b>G</b>		
Not energy efficient - higher running costs		
<b>England &amp; Wales</b>	EU Directive 2002/91/EC	

Agents Note: Whilst every care has been taken to prepare these particulars, they are for guidance purposes only. All measurements are approximate and are for general guidance purposes only and whilst every care has been taken to ensure their accuracy, they should not be relied upon and potential buyers/tenants are advised to recheck the measurements



### OFFICE ADDRESS

Putterills Lettings  
123 London Road  
Knebworth  
SG3 6EX

### OFFICE DETAILS

01462 419333  
lettings@putterills.co.uk  
www.putterills.co.uk